

Please keep!

Industrial ETHERNET Switches, 852 Series

| | |
|------------------------|--|
| 852-101 | 5-Port 100BASE-TX |
| 852-102 | 8-Port 100BASE-TX |
| 852-103 | 8/2 Port 100BASE-TX/FX |
| 852-103/040-000 | 8/2 Port 100BASE-TX/FX T (Operating temperature -40 °C ... +70 °C) |
| 852-104 | 7/2-Port 100BASE-TX/FX Managed |
| 852-104/040-000 | 7/2-Port 100BASE-TX/FX Managed T (Operating temperature -40 °C ... +70 °C) |



Before installation and operation, please read the following thoroughly and carefully. Incorrect installation may compromise safety in the event of a failure.

1. Safety Information

- Please observe the following:
- the applicable laws, standards and regulations
- the state of the art at the time of installation
- the operating instructions
- the engineering regulations
- the fact that operating instructions can only mention general regulations and that these must be observed

Before start-up, please check the device for any damage that may have occurred during shipping. The device must not be put into operation if there is mechanical damage present.

The devices described in these instructions must only be installed by a qualified electrician and must only be installed in electrical switchgear or in sealed enclosures. Improper use, or failure to follow this application note, will render the warranty or guarantee null and void.

The devices must only be installed in dry, indoor areas.

Warning:

- This is a class A product. In a domestic environment this product may cause radio interference in which case the user may be required to take adequate measures.
- Do not install the devices on or in the vicinity of easily inflammable materials. The maximum specified surrounding air temperature for this device is 60°C. Do not install this device in areas with higher temperature levels.
- Only for use in LAN, not for connection to telecommunication circuits.

2. Package Checklist

- 852-10x Industrial Switch
- Din-rail kit
- Mounting and installation instructions
- RJ45 to DB9 (female) cable (for 852-104 only)

3. Hardware Installation

1. Unpack the device. Connect the 9-48V DC (redundant) power to the power terminal block input on top panel. If required, you can connect the relay output for alarm indication. The INS-8xx Series' 6-pin terminal block offers dual DC power connection and a relay output for alarm indication.

Connect the DC power cable for primary power (PWR) and, if required, redundant power (RPS). The terminal block also provides an alarm output.

Set the DIP switch to enable the relevant alarm functions. If the alarm is connected but the DIP switch is disabled, the alarm output will not work.

2. Connect the Fiber / Ethernet (RJ45) port to the networking device. See the LNK/ACT LED to confirm if the connection is established.
3. Use the serial port to perform out of band management in 852-104.
4. See the DIP switch on top panel to enable / disable the required features for appropriate usage.

4. Location

The 852-10x can be placed on a desktop or horizontal surface and DIN-rail mounted.

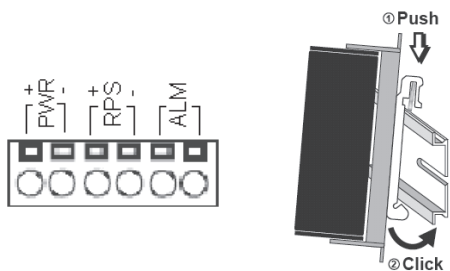

6-Pin Terminal Block

DIN-Rail Mounting

5. Default Management (852-104 only)

IP: 192.168.0.254
Subnet Mask: 255.255.255.0
Gateway: 192.168.0.1
User Name: admin
Password: Null/empty

Change the values as required.

Please note 852-101 / 852-102 / 852-103 switches have no management / IP address option.

6. RJ45 to DB9 Pin Assignment (for RS-232 console port) 852-104

852-104 offers 8-pin RJ45 console port (RS-232). The DB9 to RJ45 cable is provided with the switch. The pin assignment (see below) is for the user's reference.

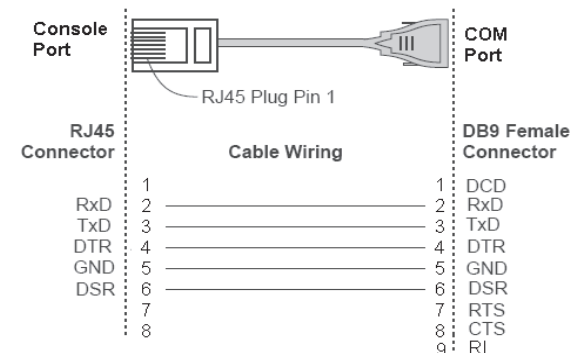

Cable Pin Assignment

7. Fiber Module and Cable Insertion (FX switches only)

1. Unpack the SFP module. Align the SFP module in front of the slot opening on a device. Insert the module into the slot until SFP module snaps into place. SFP modules normally come with a mechanism that prevents incorrect insertion.

Use thumbs and index finger to pull out the SFP module from the slot, if needed.

2. Connect the Fiber / Ethernet (RJ45) port to the networking device. See the LNK/ACT LED to confirm if the connection is established.

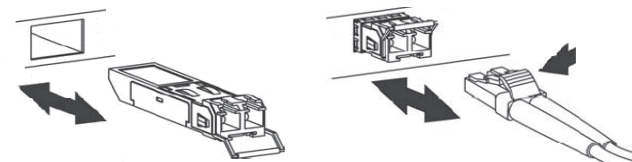

Note: Please do not twist or force the SFP module while inserting or removing the SFP module

For further details for software settings and configuration, please see the user's manual.

Should you have any further questions or concerns, please do not hesitate to contact WAGO Customer Support.